



OPERATOR'S MANUAL

- OPERATION
- MAINTENANCE
- REPAIR PARTS

SERIES

84A100

84A150

NOTICE

In cases where a 15 amp, 230 volt circuit is available and convenient, the Factory recommends you make such a conversion on your 115 volt air compressor. Modern 230 volt circuits are more than adequate to provide a constant and efficient supply of current, which is the key to maximizing the performance capabilities of the 1 H.P. and larger size air compressors. See item number 3 under "Start Up Instructions" on page 3 of this manual.

CAUTION:

Read the operator's manual carefully before attempting to operate or service this unit! **FAILURE TO COMPLY WITH INSTRUCTIONS COULD RESULT IN PERSONAL INJURY AND/OR PROPERTY DAMAGE!** SMC air compressors are precision built from the finest materials and with proper care and maintenance will perform efficiently.

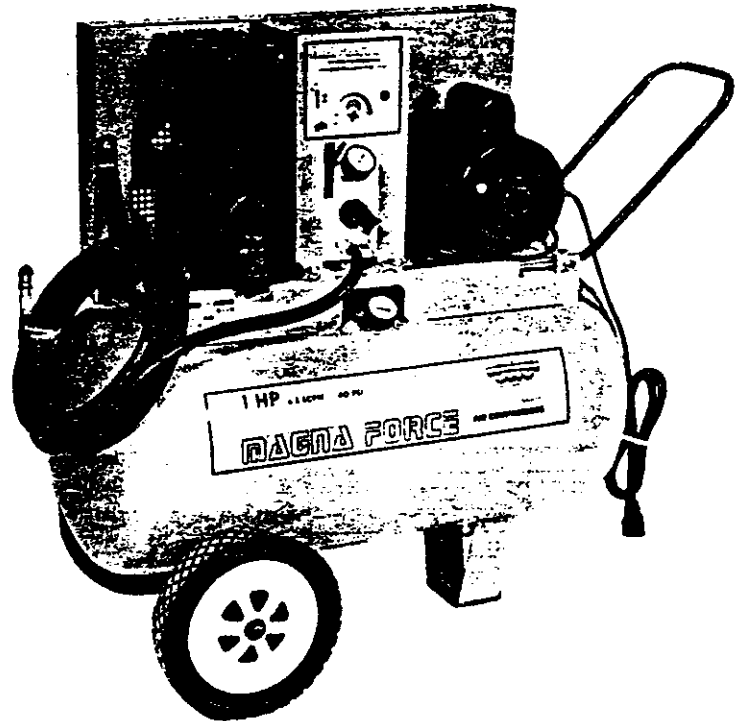

TWIN CYLINDER, ELECTRIC MOTOR AIR COMPRESSOR

Please record the model and serial number and the date the unit was purchased in the spaces below. The model and serial numbers are located on the model plate below the pump. Retain the manual with these numbers for future reference.

Model No. _____

Serial No. _____

Date Purchased _____

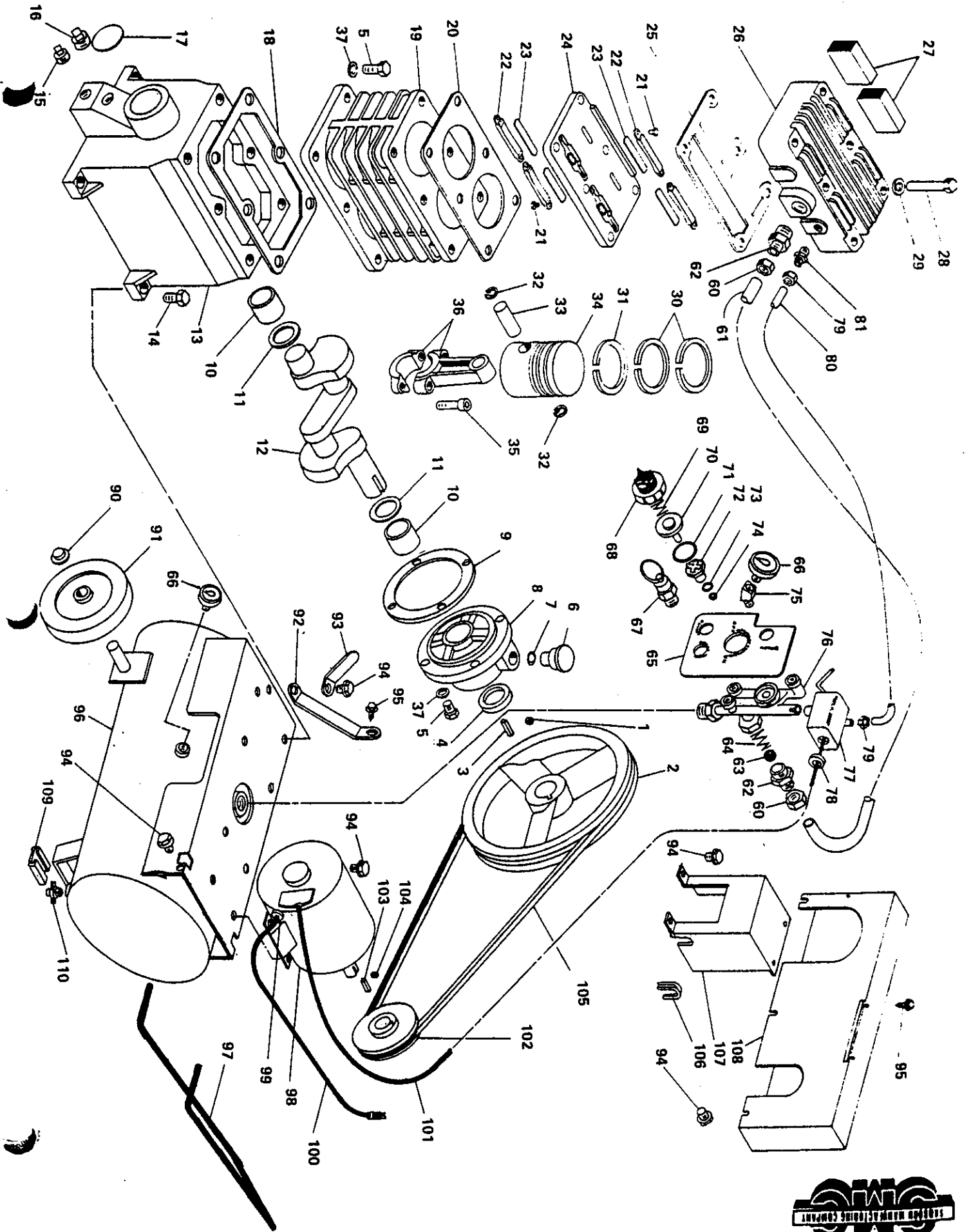

PARTS LIST



REF. NO.	PART NO.	DESCRIPTION	QUANT.
COMPRESSOR PUMP REPLACEMENT PARTS			
1	061-0002	Set screw, 5/16"	1
2	044-0006	Flywheel (A width)	1
3	146-0001	Key, 3/16" x 1" long	1
4	046-0009	Oil seal	1
5	059-0001	Bolt, 5/16" - 18 x 3/4"	10
6	056-0002	Breather	1
7	054-0010	O-ring	1
8	045-0010	Bearing plate	1
9	046-0005	Bearing plate gasket	1
10	051-0003	Journal bearing (sleeve)	2
11	060-0001	Fiber washer	2
12	053-0001	Crankshaft	1
13	049-0005	Crankcase	4
14	059-0010	Bolt, 5/16" - 18 x 1-1/4"	4
15	062-0002	1/8" oil drain plug	1
16	062-0004	3/8" oil fill plug	1
17	062-0003	Expansion plug	1
18	046-0006	Cylinder gasket	1
19	050-0009	Cylinder	1
20	046-0012	Head gasket	1
21	061-0035	No. 6-32 stickscrew 1/4" long	8
22	155-0021	Stop bar	4
23	155-0020	Flex-Leaf valve	4
24	043-0073	Valve plate	1
25	046-0014	Valve plate gasket	1
26	042-0007	Head	1
27	019-0015	Inlet filter	2
28	059-0026	Bolt, 3/8" - 16 x 2-1/2"	6
29	060-0014	Gasket washer	1
30	054-0003	Compression ring	4
31	054-0002	Oil ring	2
32	054-0009	Retaining ring	4
33	052-0001	Wrist pin	2
34	048-0002	Piston	2
35	059-0004	Bolt, 5/16" - 18 x 1-1/4" (socket head)	4
36	047-0005	Connecting rod	2
37	103-0011	Bolt seal, 5/16" I.D.	10

REF. NO.	PART NO.	DESCRIPTION	QUANT.
DIAL-O-MATIC REPLACEMENT PARTS			
60	058-0007	3/8" compression nut & sleeve	2
61	145-0004	Transfer tube, 3/8" O.D.	1
62	068-0008	Air adapter	2
63	079-0002	Ball seat	1
64	055-0007	Spring	1
65	106-0001	Face plate	1
66	032-0001	Gauge	2
67	136-0019	Pressure relief valve	1
67	136-0022	ASME pressure relief valve for all models with ASME tanks	1
68	137-0001	Knob assembly	1
69	055-0005	Regulator spring	1
70	078-0001	Regulator piston	1
71	054-0007	O-ring	1
72	105-0002	Guide	1
73	054-0040	O-ring	1
74	079-0005	Ball, 1/4"	1
75	064-0008	1/2" NPT 45° brass street elbow	1
76	041-0003	Manifold	1
77	034-0015	Pressure switch	1
78	093-0001	Rubber grommet for domestic models	1
78	071-0002	Strain relief connector for all CSA models	1
79	058-0017	1/4" compression nut & sleeve	2
80	145-0008	Bleeder tube, 1/4" O.D.	1
81	068-0002	Male connector	1

REF. NO.	PART NO.	DESCRIPTION	QUANT.
TANK ASSEMBLY REPLACEMENT PARTS			
90	033-0001	Hub cap, for 10, 12, & 14 gal. models	2
90	033-0002	Hub cap, 3/8" for 20, 22, & 30 gal. standard and 10 gal. Heavy-duty models	2
91	095-0006	Wheel, 8" x 1.75 for 10, 12, & 14 gal. models	2
91	095-0001	Wheel, 10" x 1.75 for 20 & 22 gal. models	2
91	095-0003	Wheel, 10" x 2.75 for 10 gal. heavy-duty and 30 gal. ASME models	2
92	114-0006	Belt guard bracket	1
93	114-0005	Hose bracket	1
94	059-0012	Lock bolt, 5/16" - 1 - 18 x 1/2" long	11
95	061-0005	No. 10 sheet metal screw	3
96	127-0019	10 gallon tank	1
96	151-0001	12 gallon ASME tank	1
96	127-0013	10 gallon ASME heavy-duty tank	1
96	128-0009	14 gallon tank	1
96	130-0002	22 gallon tank	1
96	152-0001	20 gallon ASME tank	1
96	153-0001	30 gallon ASME tank	1
97	112-0002	Handle (portable models)	1
98	160-0003	1 HP motor	1
98	160-0004	1-1/2 HP motor	1
99	071-0002	Strain relief connector	1
100	026-0006	Power cord, 14/3 x 6', 115 volt, 15 amp for Domestic models	1
100	026-0034	Power cord, 14/3 x 6', S.T., 115 volt, 20 amp for 84A100 CSA models	1
100	026-0038	Power cord, 14/3 x 6' S.T., 230 volt, 15 amp for 84A150 CSA models	1
101	026-0005	Interconnecting cord, 14/2 x 27" for Domestic models	1
101	026-0026	Interconnecting cord, 14/2 x 27" for CSA models	1
102	006-0005	Pulley, 2" O.D. for Domestic and 84A100 CSA models	1
102	006-0007	Pulley, 2-1/2" O.D. for 84A150 CSA model	1
103	146-0001	Key, 3/16" x 1" long	1
104	061-0006	Set screw, 5/16" - 18 x 3/8" long	1
105	007-0020	V-belt, 4L-480 (A width)	1
106	093-0003	Grommet strip	1
107	117-0002	Manifold cover	1
108	142-0001	Belt guard assembly for Domestic models	1
108	142-0012	Belt guard assembly for CSA models	1
109	094-0002	Vibration isolator (portable models only)	1
110	072-0001	1/4" petcock (tank drain)	1

REF. NO.	PART NO.	DESCRIPTION	QUANT.
ASSEMBLIES AND MISCELLANEOUS PARTS			
040-0017		Pump Assembly for SMC model 84	
165-0015		Overhaul Kit (Includes gasket set, filters, valves with screws and ring set)	
054-0066		Complete set of rings	
046-0042		Complete set of gaskets	
043-0074		Valve plate assembly (ref. nos. 20-25)	
048-0023		Piston assembly (ref. nos. 30-34)	
042-0012		Cylinder head assembly (ref. nos. 20-26 & 28)	
012-0004		Hose, 3/8" I.D. x 15' long	
018-0007		Air compressor oil, SAE 30 (recommended for use above 20° F., 1 quart)	
018-0008		Air compressor oil, SAE 10 (recommended for use below 20° F., 1 quart)	

We can switch Smith to